

**Key**

<b>01A</b> ADVANCED WARNING ACCESS TO ROAD AHEAD CLOSED ON ____ TO ____ FOR ____ DAY(S) FROM ____ TO ____	<b>01</b> ROAD CLOSED P7105 750mm	<b>02</b> Diversions ENDS	<b>03</b> Diversions ENDS	<b>04</b> Diverted traffic →	<b>05</b> Diverted traffic ←	<b>06</b> Diverted traffic ↑	<b>07</b> Diversion →	<b>08</b> Diversion ←	<b>09</b> Diversion ↑	<b>10</b> ROAD AHEAD CLOSED	<b>11</b> Diverted traffic ↘	<b>12</b> Diverted traffic ↙	<b>13</b> Diverted traffic ↻	<b>14</b> Diverted traffic ↻	<b>15</b> NO THROUGH ROUTE
--	--	---------------------------------	---------------------------------	---------------------------------	---------------------------------	---------------------------------	--------------------------	--------------------------	--------------------------	--------------------------------	---------------------------------	---------------------------------	---------------------------------	---------------------------------	-------------------------------

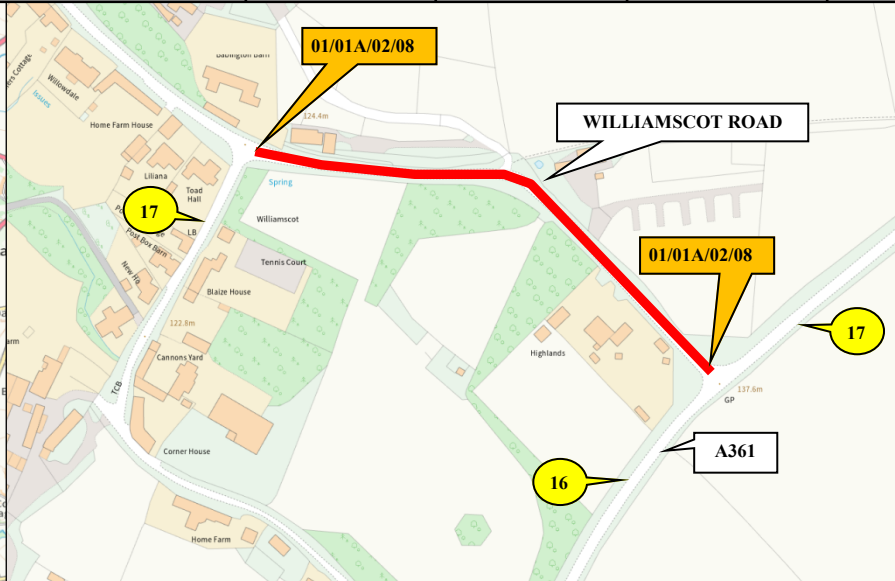
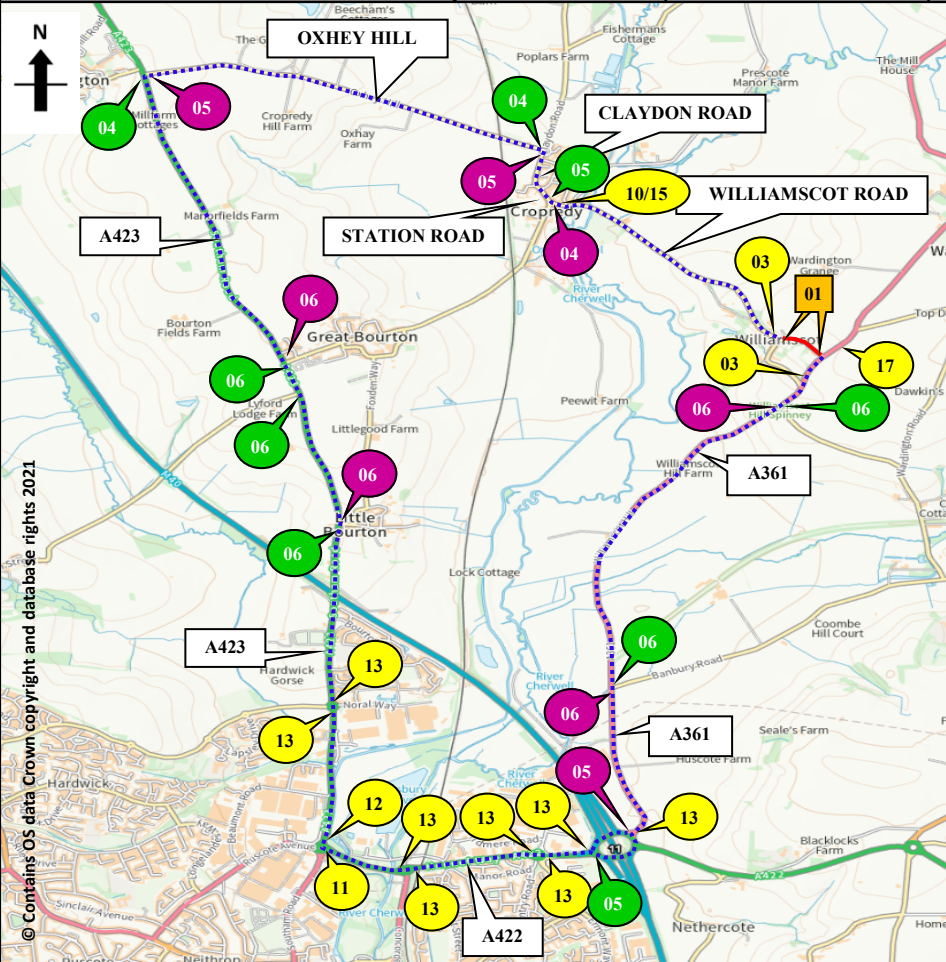

<b>16</b> ROAD AHEAD CLOSED ←
<b>17</b> ROAD AHEAD CLOSED →
<b>20</b> CYCLISTS AND PEDESTRIANS WAIT HERE TO BE ESCORTED

**What 3 Words:**  
Oils.foremost.courts

**Diversion Length:**  
10.3 Miles

**All properties within Closure points to be leaflet dropped**

**RADIOS REQUIRED**  
TM to Provide  
Openreach Engineer  
With Radio.

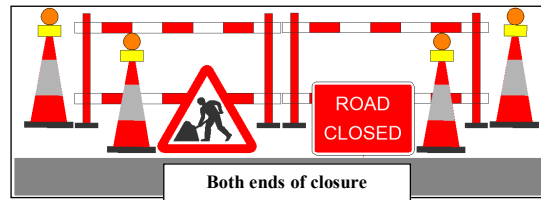

**Barriers, cones and flashing lamps required each end of road closure**

**SUNBELT RENTALS**

**Sunbelt Rentals UK (Traffic Management)**  
Kemble Airfield Enterprise Park  
Cirencester Road  
Kemble  
GL7 6BQ  
03700 500 792  
0845 004 7105

**Note**

- All equipment shall be approved and shall comply with the Department Of Transport specification MCE0111. This drawing does not show the normal road works signage that will be required as per Chapter 8.
- All signs to be in accordance with TSRGD 2016 and to minimum class retroreflective.
- Minimum height of lettering to be 60mm and sign boards to be 1000mm (750mm where appropriate).

This drawing is protected by copyright and the information contained therein is confidential.  
This drawing may not be copied and the information therein may not be used, or disclosed to a third party, wholly or in part with the written permission of Sunbelt Rentals UK (Traffic Management).

CROWN COPYRIGHT DATA REPRODUCED BY PERMISSION OF THE CONTROLLER OF HMSO

<b>CLIENT DETAILS</b>		<b>REP/DEPOT</b>	<b>DRAWN BY</b>	<b>ADDRESS</b>
OPENREACH		NB/213	NB/213	WILLIAMSCOT ROAD BANBURY OX17 1AF
<b>DATE</b>	<b>SHEET No</b>	<b>VERSION NUMBER</b>		
27/04/2023	1 OF 1	002		
<b>AMENDED DATE</b>	<b>AMENDED BY</b>	<b>SCALE</b>		
13/09/2023	DFP/213	NOT TO SCALE		
This layout is for installation by NRSWA, Lantra 12A,12B,12D qualified persons.				
				<b>BUS ROUTE AFFECTED</b>

ROAD CLOSURE	CLOCKWISE DIVERSION
DIVERSION	ANTI-CLOCKWISE DIVERSION
ROAD CLOSURE SIGN	
<b>ROAD CLOSURE LENGTH (APPROX)</b>	<b>285 M</b>
<b>ROAD CLOSURE WIDTH (APPROX)</b>	<b>2.9 M</b>
<b>Contract Number 213-S013000</b>	